



## St. Marys Terrace, Hastings TN34 3LR

Offers in excess of £875,000



Five bedroom, four storey Georgian townhouse with parking set within one of Hastings MOST SOUGHT AFTER ADDRESSES with exquisite, UNINTERRUPTED VIEWS across the town and of the English Channel. It's enviably located within walking distance of Hastings Old Town, the beach and Hastings Town Centre where there is a mainline railway station with connections to London. Spanning FOUR STOREYS the accommodation here enjoys a versatile layout boasting a WEALTH OF ORIGINAL FEATURES. The ground floor is arranged as a bright, BAY FRONTED RECEPTION ROOM with an open fireplace and an additional room which measures 14 x 10'11, with an attached shower room with w/c it would make a lovely bedroom. There is also a UTILITY ROOM on the entrance level with access to a courtyard garden while the first floor houses the main living accommodation. The living room enjoys a floor to ceiling bay window with double doors opening to a private balcony while the kitchen/breakfast room spans the rear of the property with bi-folding doors leading to the tiered garden. There are four double bedrooms arranged over the upper two

GROUND FLOOR  
624 sq.ft. (57.6 sq.m.) approx.

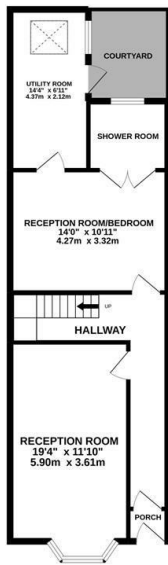

1ST FLOOR  
513 sq.ft. (47.5 sq.m.) approx.

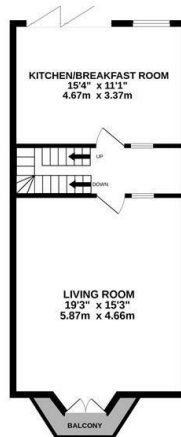

2ND FLOOR  
505 sq.ft. (46.9 sq.m.) approx.



3RD FLOOR  
505 sq.ft. (46.9 sq.m.) approx.

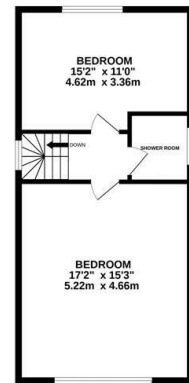

TOTAL FLOOR AREA : 2136 sq.ft. (198.5 sq.m.) approx.

Whilst every attempt has been made to ensure the accuracy of the floorplan contained here, measurements of doors, windows, rooms and any other items are approximate and no responsibility is taken for any error, omission or mis-statement. This plan is for illustrative purposes only and should be used as such by any prospective purchaser. The services, systems and appliances shown have not been tested and no guarantee as to their operability or efficiency can be given.

Made with Metropix ©2022

